

### ● Applications:

- \* For applications with high dynamic pressure pulsations or vibration a liquid filled case and socket restrictor are available
- \* Suitable for corrosive environments and gaseous or liquid media that will not obstruct the pressure system
- \* Process industry: chemical / petrochemical, power stations, mining, on and offshore, environmental technology, mechanical engineering and plant construction.

### ● Features:

- \* Dial: 4.5" (115mm) white aluminum with black and red markings
- \* Safety glass window, adjustable pointer, dry and fillable
- \* Bottom 1/2" NPT, 316 stainless steel.
- \* Bourdon tube: 316L stainless steel, less than 1000PSI, C-type, More than 1,500PSI, Helical type
- \* Pressure element: 316L Stainless steel
  - < 100bar: C-type
  - ≥ 100bar: helical type
- \* Movement: Stainless steel
- \* Dial: Aluminium, white, black lettering, pointer stop pin
- \* Pointer: Adjustable pointer, aluminium, black
- \* Case: Phenolic case. Solid front. Blowout back option available upon request.
- \* Window: Clear non-splintering plastic (PMMA), retained by internal threaded bezel
- \* ASME B40.100 and EN837-1 compliant



ROCKAGE®

Specifications	
Dial	4.5" (115mm)
Case	Phenolic case. Solid front. Blowout back option available upon request.
Lens	Safety glass Bayonet ring and restrictor screw
Socket	316L SS
Connection	1/4" NPT or 1/2" NPT
Movement	Stainless steel
Pointer	Black aluminium, adjustable
Welding	TIG
Over-pressure Limit	25% of full scale value
Working Pressure	Maximum 80% of full scale value
Ambient/Process Temperature	-40°F to 200°F (-40°C to 93°C) Dry -4°F to 150°F (-20°C to 65°C) Glycerin-filled
Accuracy	±1.0% and ±0.5% ANSI/ASME Grade 2A

# Process Pressure Gauge

ROCKAGE®

**Product Code** (Scales kPa, bar, kg/cm<sup>2</sup> ... available)

Dial Size	4.5"(115mm)			
NPT Connection	1/4" Bottom	1/4" Lower Back	1/2" Bottom	1/2" Lower Back
30"Hg Vac				
30"/0/15 psi				
30"/0/30 psi				
30"/0/60 psi				
30"/0/100 psi				
30"/0/160 psi				
30"/0/200 psi				
30"/0/300 psi				
0/15 psi				
0/30 psi				
0/60 psi				
0/100 psi				
0/160 psi				
0/200 psi				
0/300 psi				
0/400 psi				
0/600 psi				
0/1,000 psi				
0/1,500 psi				
0/2,000 psi				
0/3,000 psi				
0/4,000 psi				
0/5,000 psi				
0/6,000 psi				
0/7,500 psi				
0/1,0000 psi				
0/1,5000 psi				

**Available in these sizes  
and materials.**

## Bottom Connection

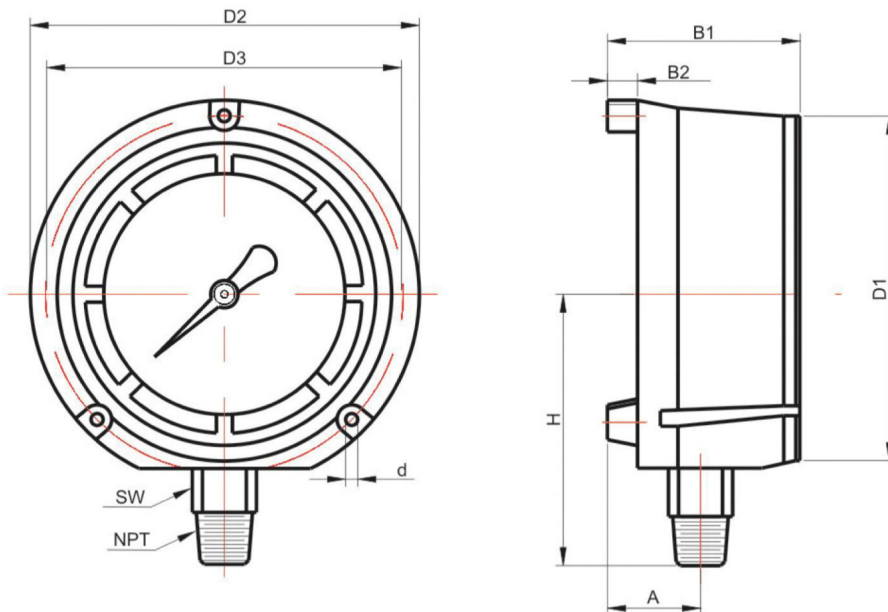

Dial Size	D 1	D 2	D 3	d	B 1	B 2	A	H	SW
4.5"	5.118" (130mm)	5.827" (148mm)	5.394" (137mm)	0.236" (6mm)	3.425" (87mm)	0.669" (17mm)	1.614" (41mm)	4.016" (102mm)	0.669" (17mm)

ROCKAGE®