



Válvulas tipo Mariposa.





General features

Materials of standard execution:

Body:

Spheroidal cast Iron GGG 50 (A536 65-45-12) ,
Epoxy coated or Rilsan coated.
(standard for body)

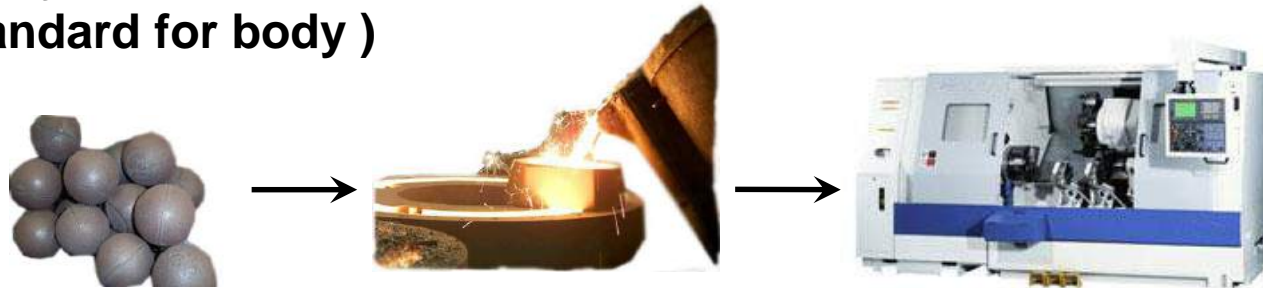

Used for general applications, spheroidal cast Iron GG50 has higher resistance against bending and mechanical stress compared to GGG25 cast iron

OTHER BODY MATERIALS ON REQUEST



WAFFER Butterfly valve standard available:



Direct coupling to actuator

ISO 5211 (DN40-DN300)

Standard flanges:

PN10-PN16 suitable for ANSI 150 FLANGES

from DN40 to DN 300

PN10 from DN350 to DN 600

Temperatures:

Working Temperature	From	to
EPDM	-40°C	+135°C
NBR	-23°C	+82°C
FKM	-10°C	+190°C
PTFE	-25°C	+150°C
Silicone	-50°C	+160°C
NBR carbox	-10°C	+82°C
HNBR	-30°C	+100°C

Version with no seat reaches 500°C

☸ LUG Butterfly valve standard available:

Direct coupling to actuator

☸ ISO 5211

Standard flanges:

☸ PN 10/16 from DN 40 to DN 150

☸ PN 10 from DN 200 to DN 300

☸ PN 16 from DN 200 to DN 300 (on req.)

Temperatures:





Working Temperature	From	to
EPDM	-40°C	+135°C
NBR	-23°C	+82°C
FKM	-10°C	+190°C
PTFE	-25°C	+150°C
Silicone	-50°C	+160°C
NBR carbox	-10°C	+82°C
HNBR	-30°C	+100°C

Version with no seat reaches 500°C

The main components

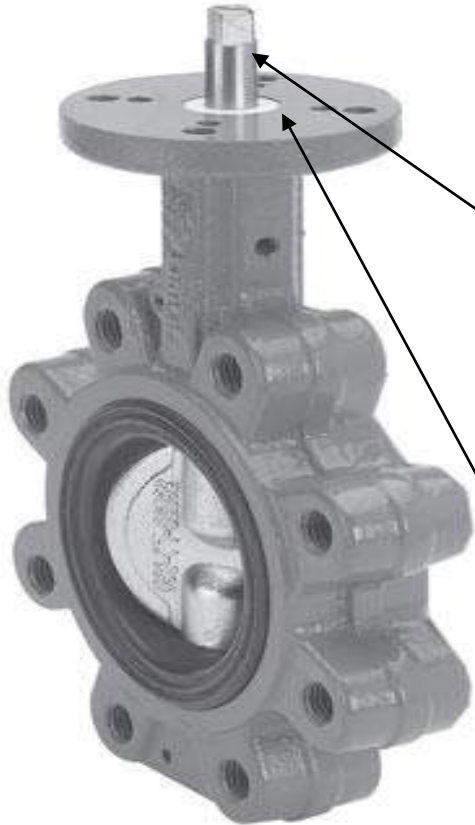
LUG & WAFER type Butterfly valve



 2 Pieces Shaft:
AISI 420 (17-4PH on req.)
In order to achieve a higher Kv
A thinner disk in the central part

 PTFE bushes



Perfect alignment of the stem and low friction
Between shaft and body



The main components

LUG & WAFER type Butterfly valve



Disc	Features	Applications
A536* (Cast iron)	Good mechanical strength	General applications
AISI 316	Excellent corrosion resistance	Water, chemicals, steem...
AISI 316L	Excellent mechanical & corrosion resistance	Water, chemicals, steem...
AISI 316L polished	Excellent mechanical & corrosion resistance	Food , chemical, pharmaceutical
Bronze Alluminio	Excelent corrosion resistance	Corrosive fluids , sea water



Liner	Features	Applications
EPDM	High temperature resistance	Water, steam, diluted acids, alcohol
NBR / white NBR	High mechanical resistance	Compressed air, hydraulic fluids, abrasive material, oil grease, lubricants, fat
FKM	Excellent chemical and mechanical strength to heat	Solvents, pharmaceutical (no steam)
Potable water NBR	According to Italian Law D.L. 174/2004	Potable water
Carbox NBR	Good abrasione resistance	Abrasive powder and fluids
Silicone	Excellent chemical, and heat resistance	Air and hot inert gas, food industry, steam
PTFE on EPDM	On request - O-ring on stem EPDM	Food industry other Other applications with non-hazardous fluids

Cast Iron Coating:

LUG & WAFER type Butterfly valve

Body coating		
Epoxy coating	Durable coating with exceptional abrasion and chemical resistance	Suitable for valves in water and wastewater applications
Rilsan coating	High finishing electrostaic uniform thickness coating	Gives high protection to steel, cast iron and aluminum when used in harsh invironement



Details & Features:

☰ Shaft in 2 pieces:

ADVANTAGES:

- ☰ Better Kv, less pressure drop thanks to a wider section through which the media flows
- ☰ Thinner disc section in the central part simplifies the maintenance

☰ Polished Hedge disk

ADVANTAGES:

- ☰ Better tightness
- ☰ Lower wear
- ☰ Lower torque

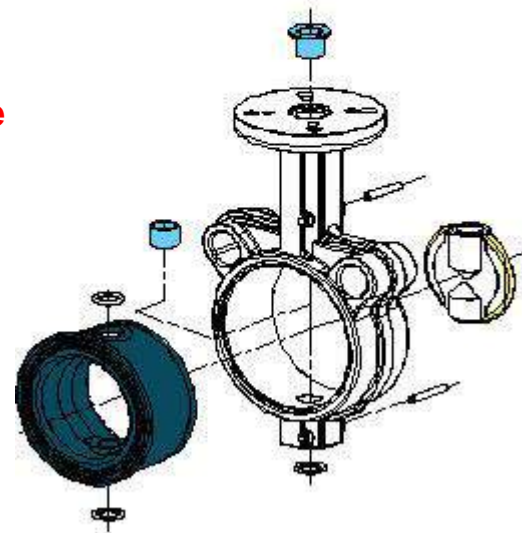

Details & Features:

☰ The Liner

☰ Vulcanized liner on a backing ring (bakelite)

☰ Shoulder for easy and precise replacement



ADVANTAGE:

☰ The liner is easy to remove and to replace, very low deformation after closing between the flanges

☰ More resistance to stress and

Backelite ring

Vulcanized rubber

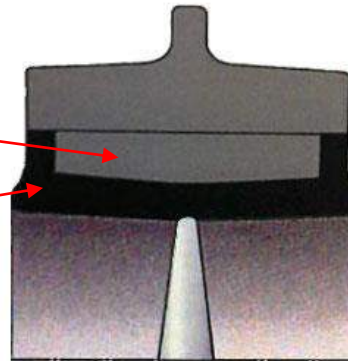

Details & Features:

 **Liner vulcanized on a hard ring**



 **Shape liner:**

Flat space for tightness

**Conical shape
for a better disk
entry**

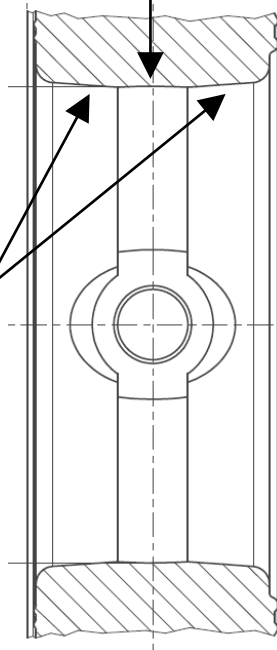

ADVANTAGES:

- **Better tightness**
- **Lower wear**
- **Lower torque**



Details & Features:

The stem-disk connection

Connection between stem and disk is realized through a square coupling key. This allows a perfect contact between two elements and reduces the risk of wear. Very easy maintenance and replacement

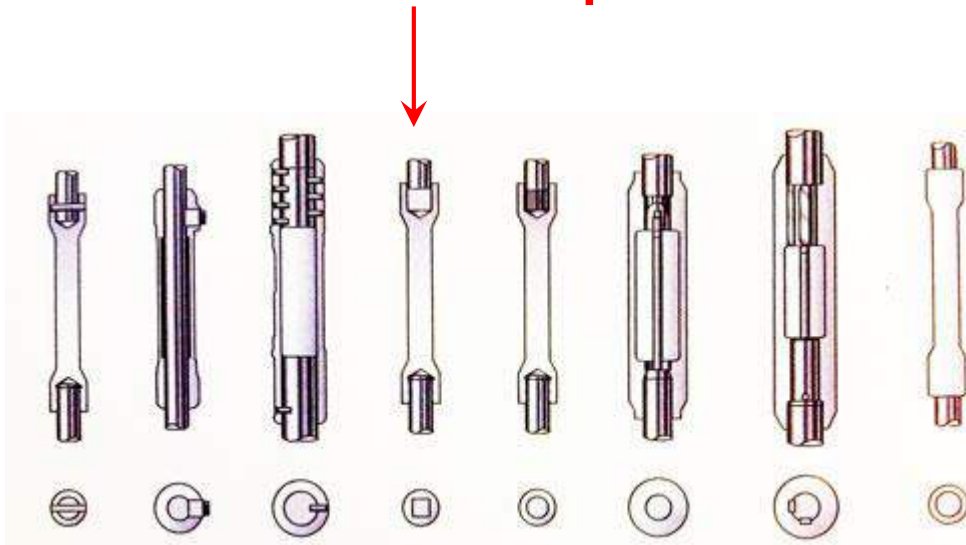

Details & Features:

- Butterfly valve with manual Lever/Gear box
- Lever: A special jagged ring where 2 cogs will guarantee a perfect 10 intermediate positioning of the handle angle. The ON-OFF positions are also lockable. The top of the lever is graduated to show the angle position
- Manual Gear box: especially for big size to move easily the valve. The top is graduated to show the angle position

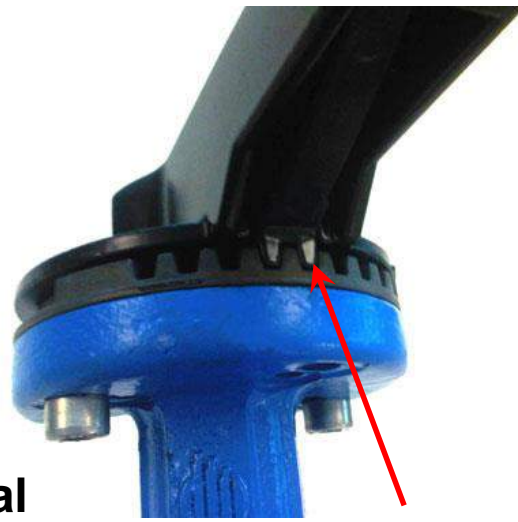

2 cogs



OPEN - CLOSE

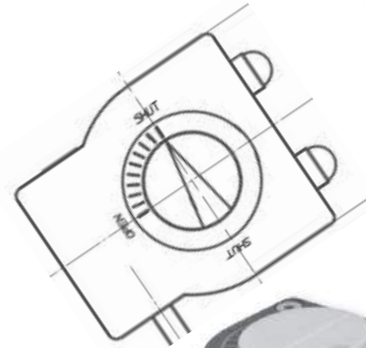

Details & Features:

 **Antistatic device:**

ADVANTAGES:

 **Ensure that all components are grounding**

**THE DEVICE MEETS THE STANDARD:
GROUP II CATEGORY 2a G-D
GAS & DUST ZONE 1-2G & 21-22D
“C” CONSTRUCTIONAL SAFETY**

 **Atex certification available on request**

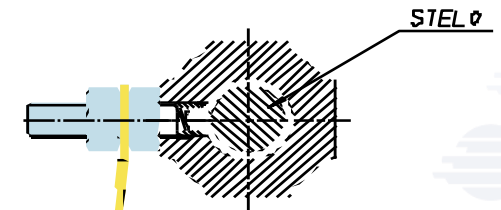
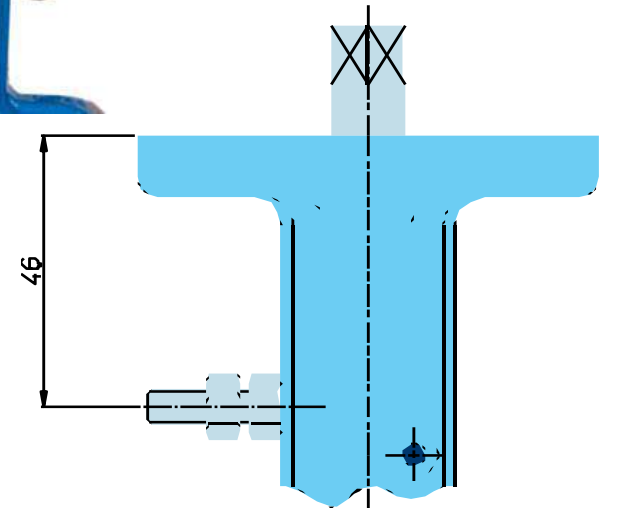
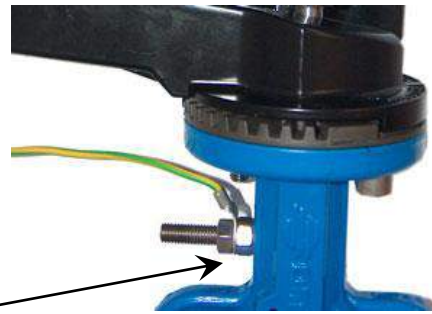

Details & Features:

Standard ISO 5211 connection
with connectors KCF....

ADVANTAGES:

- Standard connection toward actuator,
- Thanks to this standard it's easy to mount:
Lever, manual gear, pneumatic and electric
actuator

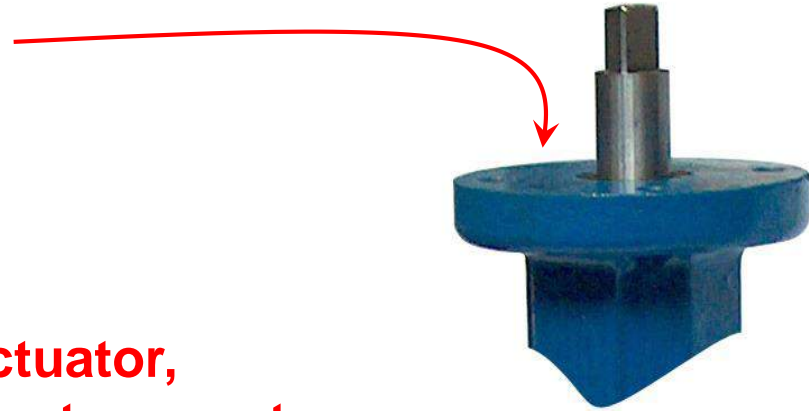

These valves are suitable to be used in:

- Fully open or close bidirectional service
- Flow regulation
- Frequent operating cycles
- Low pressure drop through the valve
- Suitable for abrasive media according to material





POSSIBLE APPLICATION FIELDS

- WATER DISTRIBUTION & TRATMENT
- SUGAR PROCESSING
- TANK TRUCK
- CEMENT FACTORY
- CENTRAL DIARY
- VACUUM PLANT
- PAPER FACTORY
- OIL INDUSTRY
- WINE PRODUCTION
- FOOD
- CONVEYORS PNEUMATIC TRANSPORTATIONS
- GAS AND AIR TRANSPORT
- SEA WATER DESALINATION
- DISTILLERIES
- DAMS AND LEAPS
- CHEMICAL
- COOLING IN STEEL PRODUCTION
- HYDRAULICS
- HEATING AND AIR CONDITIONING
- IRRIGATION

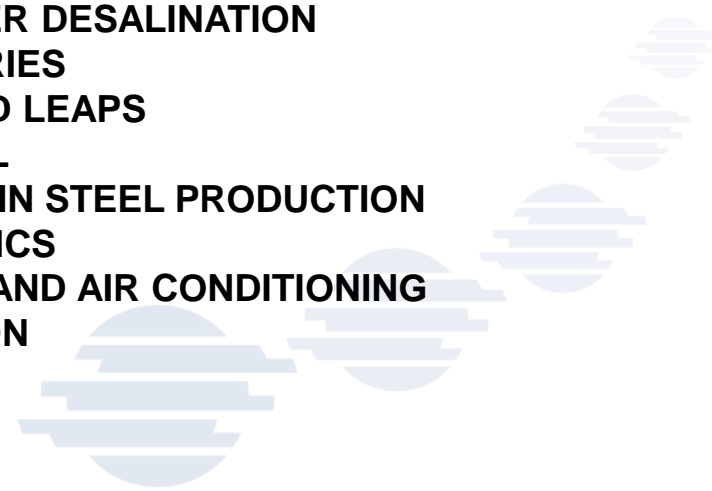

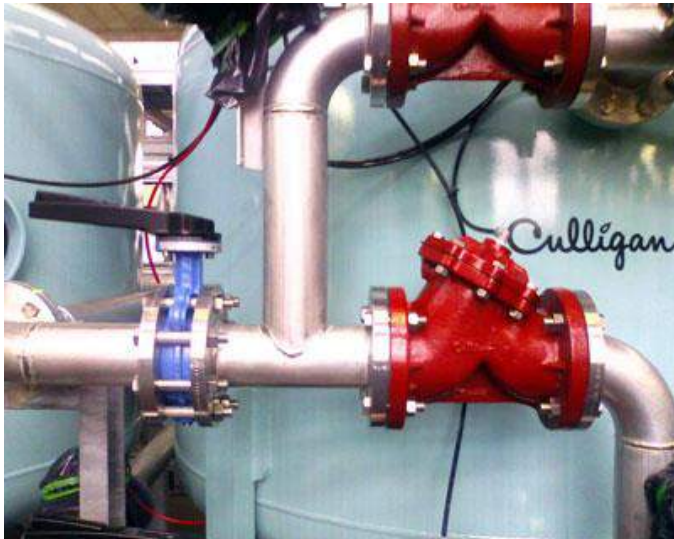

POSSIBLE APPLICATION FIELDS

- FOOD
 - SUGAR PROCESSING
 - TANK TRUCK
 - CEMENT FACTORY
 - CENTRAL DIARY
 - VACUUM PLANT
 - PAPER FACTORY
 - OIL INDUSTRY
 - WATER PURIFIERS
 - WINE PRODUCTION
-
- WATER TREATING AND TRANSPORT
 - GAS AND AIR TRANSPORT
 - SEA WATER DESALINATION
 - DISTILLERIES
 - DAMS AND LEAPS
 - CHEMICAL
 - STEEL PRODUCTION
 - HYDRAULICS
 - HEATING AND AIR CONDITIONING
 - IRRIGATION

REVERSE OSMOSIS PLANT:



Butterfly valve in Reverse Osmosis plant



LPG GAS PLANT:

**OMAL's butterfly valves are certified DVGW for gas
+ ATEX for explosive atmosphere**



PNEUMATIC TRANSPORT PLANT:

OMAL's butterfly valves are certified ATEX suitable to transport difficult, abrasive or friable materials as electrostatic dust involves an explosive atmosphere.

Carbox NBR is a suitable liner resistant against wear caused by particles carried by the compressed air in the circuit.

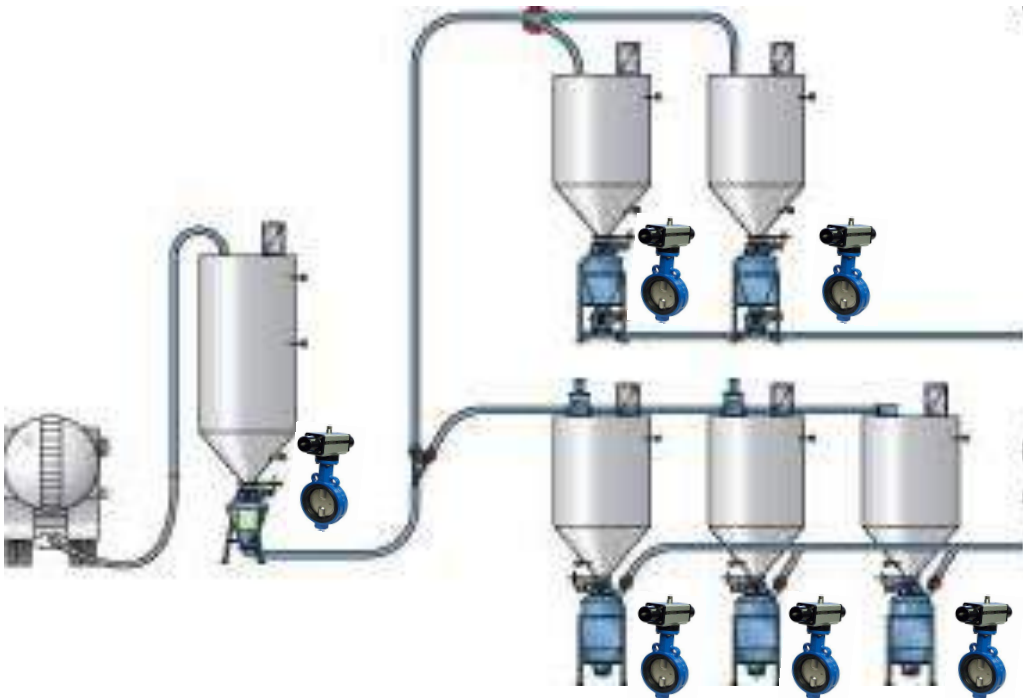

MORE FEATURES:

- Light weight , compact & convenient
- Doesn't need lot of maintenance
- Minimum number of moving components
- Doesn't have cavities
- Higher Flow
- Straight flow direction

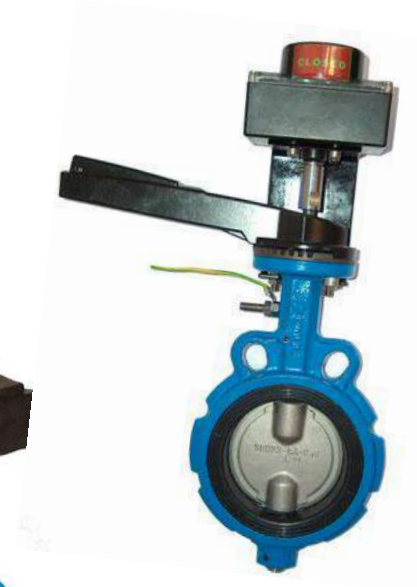

Certificates:

 **ATEX II 2GD Directive 94/9/EC?**

**On request for use in potentially
explosive atmospheres GAS & DUST.**



Approvals:

- According to 97/23 EC PED
- DVGW for gas (V376)
- RINA: Italian nNaval Institute
- DRINKING water according the italns lows

Suitable when intercepting water and alimentary fluids (V376)

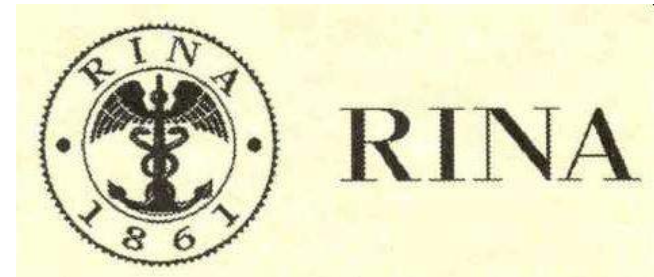

METAL to METAL - FEATURES



- **NO tightness - approximately leakage 2%**
- **WAFER type for flanges PN10-16, ANSI 150**
- **Size DN40 to DN200 (above up on request)**
- **Face to face as per ISO 5752**
- **Temperature from – 50 °C to 100 °C**
- **Available up to 500 °C application with smoke**
- **Available in Cast iron (V270) or SS 316 (V474)**
- **Top valve according to ISO 5211 for actuators or hand lever or gear box**
- **Applications:**
 - **Air or smoke without pressure**
 - **Flow control (with positioner) never close 100%**
 - **Non abrasive sand or dust, fine and without pressure**

PVC



- ☸ **WAFFER flanges PN10-16**
- ☸ **Face to face as per ISO 5752**
- ☸ **Size & working pressure: DN 40 & DN 50 16 bar max.
DN 65 – DN250 10
bar max.
DN 300 8
bar max.**

- ☸ **Material Body: Polypropylene fiber glass reinforced**
- ☸ **Disc: PVC- C (on req. PP- H; PVDF)**
- ☸ **Sat: EPDM (on req. FPM; NBR)**
- ☸ **Top valve as per ISO 5211 for actuators (with bracket) or manual lever or manual gear box**
- ☸ **Applications: Chemical industry, all kind of fluids compatible with PVC-C and EPDM or other seat and disk material available on req.**



Stainless Steel



- **Body, disk and stem: AISI 304 (on req. AISI 316)**
- **Seat: FQM (Silicone)**
- **Working pressure: 6 bar max**
- **Temperature up to 150 °C**
- **Connections:** Threaded ISO 228G
DIN 11851 (food industry connections)
Butt-weld as per DIN 11850-1
TRI-CLAMP (pharmaceutical industry)
- **External surface: Polished**
- **Application: Food industries**





Para mas Información
Contáctenos.



INDUSTRIAS ASOCIADAS S.A.S.
INSTRUMENTACIÓN PARA LA INDUSTRIA

www.industriasasociadas.com

ventas@industriasasociadas.com

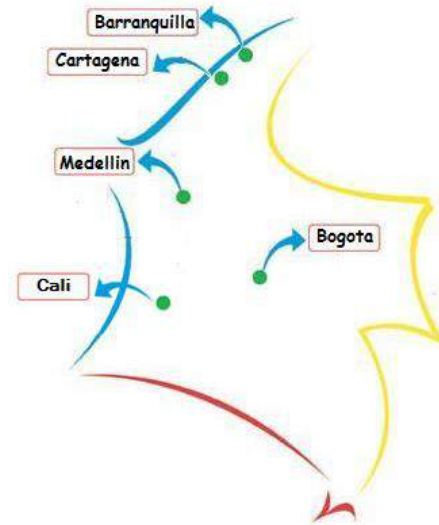

BOGOTÁ D.C.
PBX (1) 371 2999
BARRANQUILLA
Tel. (5) 372 3704
CARTAGENA
Tel. (5) 674 7138
CALI
Tel. (2) 385 1147
MEDELLÍN
Tel. (4) 448 6667

30
años

